

HTC-1K SERIES

MINI DOMED CAMERA

HUNT ELECTRONIC CO., LTD.



FEATURES

- IP68
- DSP color camera
- Auto trace white balance
- 2H mode aperture correction
- Electronic Shutter up to 1/100,000 sec
- Night vision available for color camera

SPECIFICATIONS

ITEMS	COLOR
Pick-up Device	1/3" or 1/4" CCD image sensor
Picture Elements (H*V)	Sony : NTSC: 510*492, PAL:500*582 Next chip: NTSC: 512*492, PAL:512*582
H. Sync. Frequency	NTSC: 15.734 KHz , PAL: 15.625 KHz
V. Sync. Frequency	NTSC: 59.94 Hz , PAL : 50 Hz
Synchronization	Internal
Horizontal Resolution	380 TVL
Back Light Compensation	AUTO
Electronic Shutter	AUTO, Range:1/50(1/60)~1/100,000 sec.
Gain Control	AUTO
Lens	3.6mm
Gamma Correction	0.45
S/N Ratio	More than 48 dB
Video Ourput	1Vp-p, 75 Ohms
Dimension mm	φ 79 * W72
Power Supply	12V DC only
Power Consumption	90mA / 100mA (Hi-res.)
Weight gr	350
Storage Temperature	-30°C ~ +60°C
Operation Temperature	-10°C ~ +45°C

SPECIFICATIONS ARE SUBJECT TO CHANGE WITHOUT NOTICE

Model	Image	Color	Med-res.	Hi-res.	Chips	Sensitivity (F1.2) Lux	Resolution (TV lines)
HTC-1KB	1/3"	0	0		Sony	0.05	420
HTC-1KF	1/4"	0	0		Sony	0.5	380
HTC-1KJ	1/4"	0	0		Next chip	1	380
HTC-1KI	1/3"	0		0	Sony	0.1	540

INTERFACE

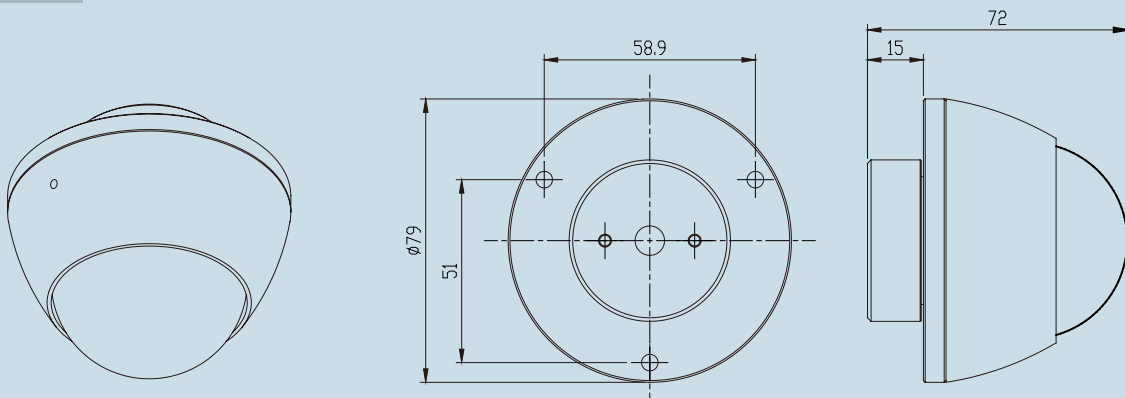

Digital Surveillance System

Camera

Rear View System

Accessories

Appendix